

**INSTALLATION GUIDE**

**Barrina®**

**T8**

**FIXTURE**

# Barrina LED T8 LIGHT FIXTURE

## MANUAL

### DESCRIPTION

Barrina LED T8 Light fixture provide high performance, long life and energy savings in a simple, no-frills conventional looking fixture.



Energy Efficient  
Cost Savings in Monthly Bills



High Luminous Efficacy  
More lumens for your watt



Runs on Direct Power Supply  
Instant On & Flicker Free



Quality & Durability  
Long Lifespan

### INSTALLATION DRAWING



Disconnect power before installation.

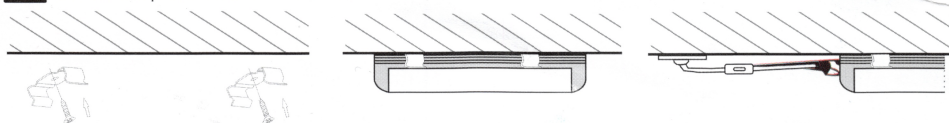

When connecting 4ft T8 shop light fixture in a series, please don't connect more than 6 lights.

When connecting 8ft T8 shop light fixture in a series, please don't connect more than 3 lights.

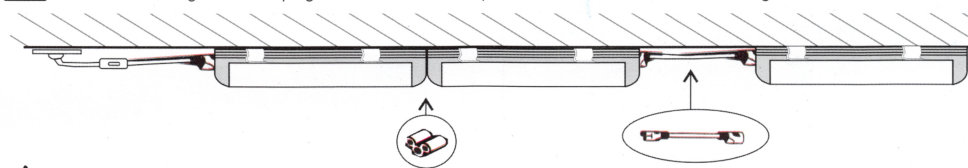

Hardwire guide:

Live wire(L) = Black wire = Brown wire; Null wire(N) = White wire = Blue wire;  
Earth wire(E)= Yellow/Green wire;

### WARNING

1. Please read specification first to make sure service environment matches the conditions in the specifications
2. Product is for indoor use only.
3. Unauthorized personnel is not allowed to disassemble the product.
4. Damaged external cables should be replaced by manufacturer, service agent or by trained professional.
5. Product should not be subjected to mechanical stress.
6. Keep away from direct sunlight or high-temperature.
7. If there any damage on the power line or the shell of the product, it should be taken as defective and must not be used.

## WARRANTY

### 3-YEAR WARRANTY

These lights have 3-year warranty. If you have any problem during using our products, please feel free to contact seller, and a member of our support team will be in touch within 24 hours to provide a resolution to the issue.